

# Repair Your Own Screens



1. For both fiberglass and aluminum, the screening should be cut at least 1" larger than the frame. With aluminum screen, the corners also have to be cut on a 45 degree angle (approx. 1/2" from corner). This will make tucking in the corners easier.



2. **FIBERGLASS SCREENING:** Start at the corner and gently roll the spline and screen into the groove.  
**ALUMINUM SCREENING:** Before installing the spline, use the tool to pre-crease the screen into the groove. When completed, start at one corner and gently roll spline into the groove.



3. At each corner, tuck the spline into the frame. Use a sharp knife to trim off the excess screen. When using fiberglass, wrinkles may be corrected by removing spline in any area, pulling screen mesh tight, and rerolling spline.

## Using A Screen Installation Tool

1. If using aluminum screening, use convex end of tool. Angle tool to the outside of the frame and gently crease window screening into the screen frame.
2. If using fiber glass screening, use the concave end of tool, start at one corner and roll spline down into the groove.

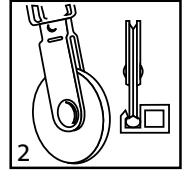
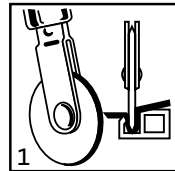

## Screen Selection Tips

### Color

- Black is the least visible from the exterior of your home or office.
- Black features less glare and is easier to see through from the inside.

### Screen

#### Fiberglass

- Lightweight
- Easiest to install
- UV and weather resistant
- Ideal for most applications

#### Aluminum

- Heavy duty
- More difficult to install
- UV and weather resistant
- Ideal for high traffic areas

#### Super Tough™

- Heavy duty
- More difficult to install
- UV and weather resistant
- Withstands the wear and tear of most pets



#1439

# Repair Your Own Framed Screen



Screen not included



To Repair Damaged Frames Use Our Convenient Screen Frame Kit

- Assembles in minutes
- No mitre cuts required
- Convenient snap-in corners
- Durable aluminum frame
- Available in white or brown
- Widths Available:  
36" (89.9 cm) 48" (120.1 cm)  
60" (149.9 cm)



1. Cut frame to length



2. Snap frame together and install screen

## Screen Repair Kit



- Kit Contains:
- Black fiberglass screening
  - Spline
  - Screen installation tool
  - Easy step-by-step instructions

Sizes Available:

- 36" (89.9 cm) width x 84" (213.3 cm) length
- 48" (120.1 cm) width x 84" (213.3 cm) length

## Adjustable Window Screens



- Adjustable width to fit a range of window sizes
- Durable aluminum frame
- Black fiberglass screening
- Available in a variety of sizes

Sizes Available:

Height	Width (open/close)
8" (20.3 cm)	14" / 24"
10" (25.4 cm)	20" / 37"
12" (30.5 cm)	23" / 42"
10" (25.4 cm)	24" / 44"
18" (45.7 cm)	21" / 38"

#1439